

Smith County Courthouse Furniture Update
May 2026

fitzpatrick
ARCHITECTS





BUILDING STATISTICS

268,426 OCCUPIABLE SQUARE FOOTAGE

280,426 TOTAL BUILDING SQUARE FOOTAGE

± 30,000-35,000 SQUARE FEET PER FLOOR

220+ STAFF OCCUPYING BUILDING

1,000+ POTENTIAL PUBLIC VISITORS

9 COURTROOMS

CENTRAL JURY ASSEMBLY

LAW LIBRARY

DEPARTMENTS

SECURITY

DISTRICT CLERK

COUNTY CLERK

JUDICIAL COMPLIANCE

PRE-TRIAL RELEASE

5 DISTRICT COURTS

3 COUNTY COURTS AT LAW

GRAND JURY

DISTRICT ATTORNEY

12TH COURT OF APPEALS

FACILITIES

BAR ASSOCIATION

INTERPRETERS

130 OFFICES

40 CONFERENCE ROOMS

60 WORKSTATIONS

2,000+ CHAIRS

GUEST CHAIRS

CONFERENCE CHAIRS

OFFICE CHAIRS

COURTROOM SEATING

PUBLIC AREAS

CHAIRS

BENCHES

TABLES

SOFAS



PUBLIC AREAS



Finishes shown may not be representative of final color selections



FIRST FLOOR PLAN





Finishes shown may not be representative of final color selections



Finishes shown may not be representative of final color selections



Finishes shown may not be representative of final color selections



Finishes shown may not be representative of final color selections



SECOND FLOOR PLAN

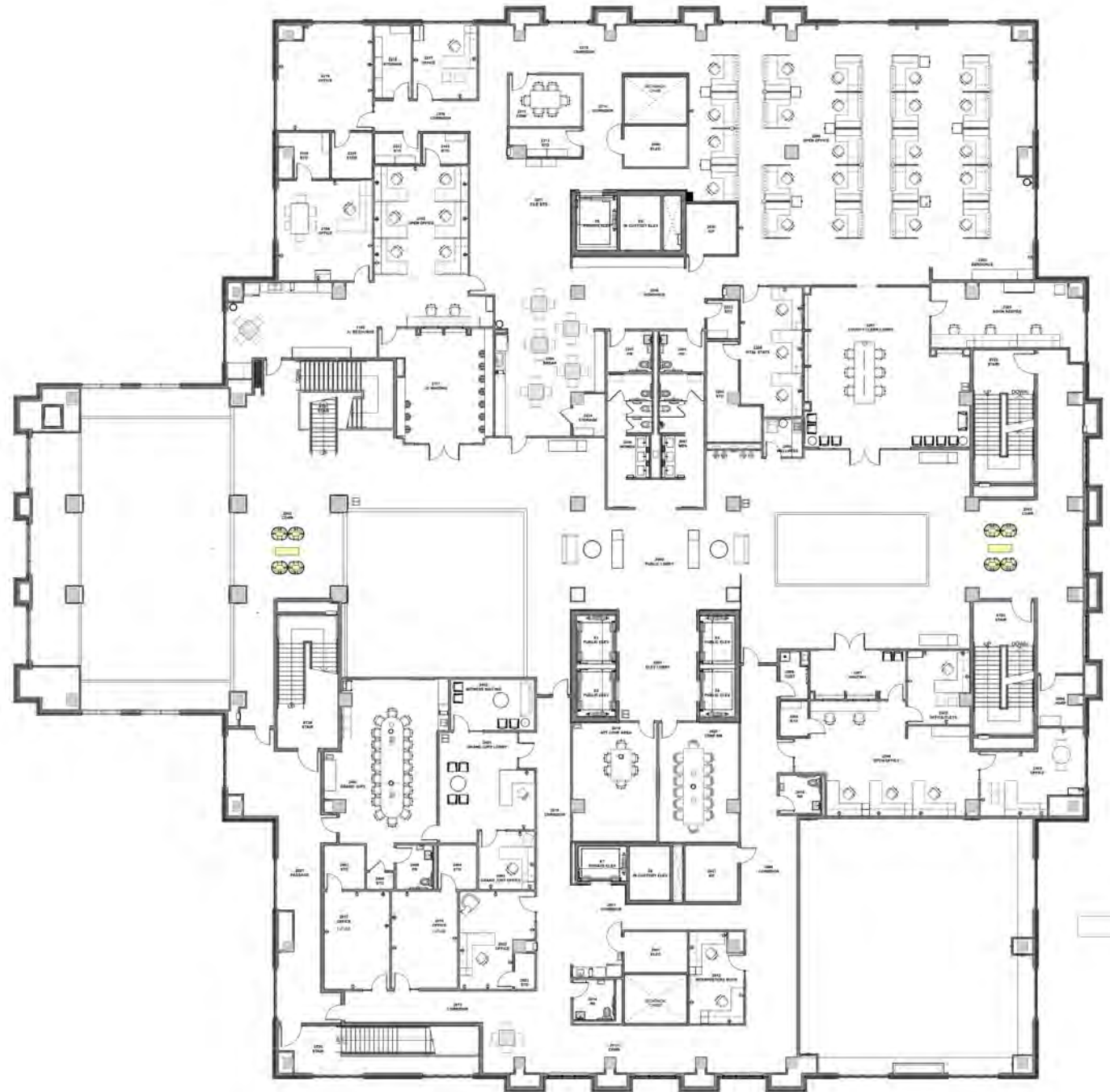



Finishes shown may not be representative of final color selections



Finishes shown may not be representative of final color selections



PUBLIC AREAS



Finishes shown may not be representative of final color selections



THIRD FLOOR PLAN

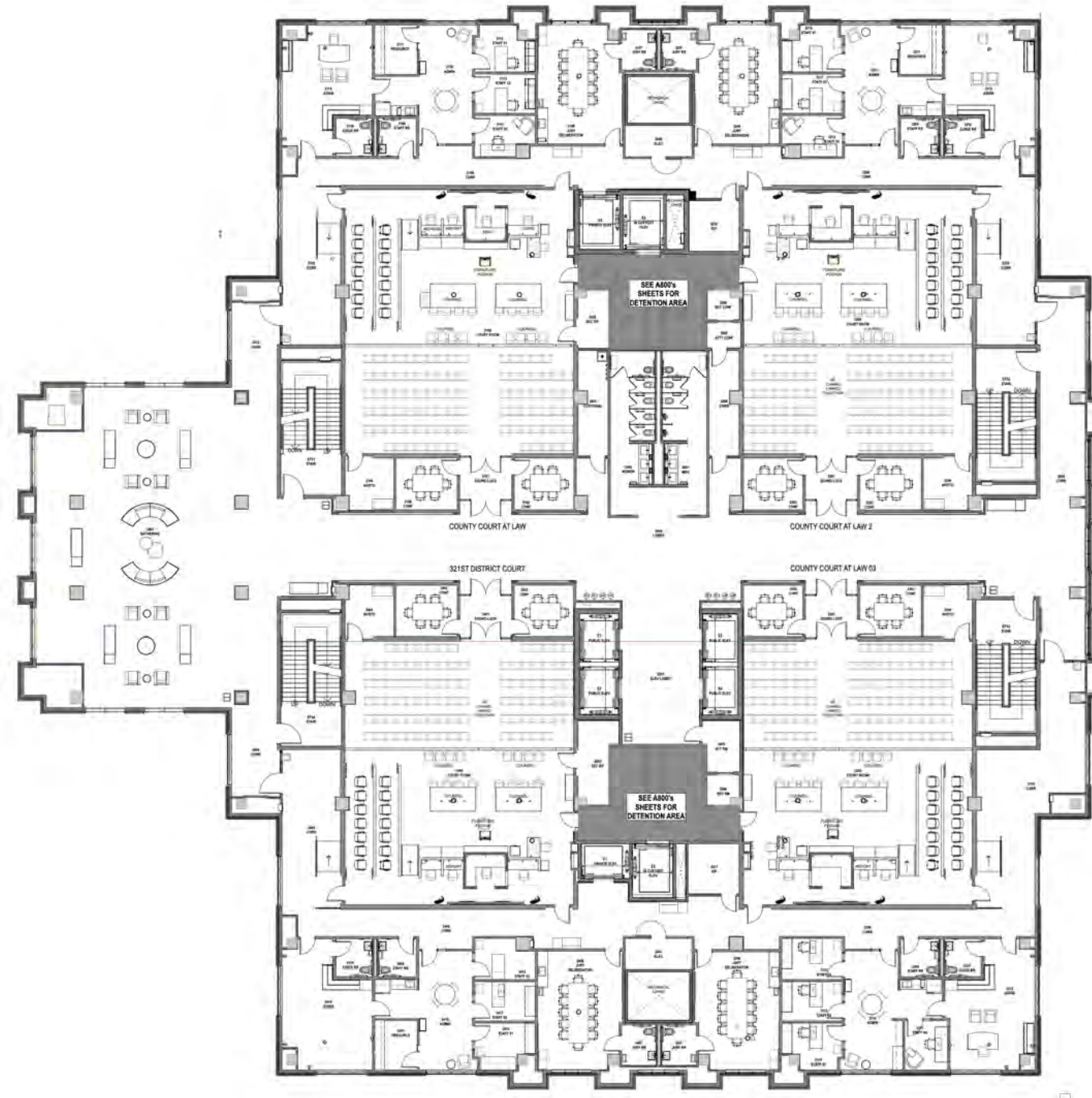



Finishes shown may not be representative of final color selections



COURTROOMS

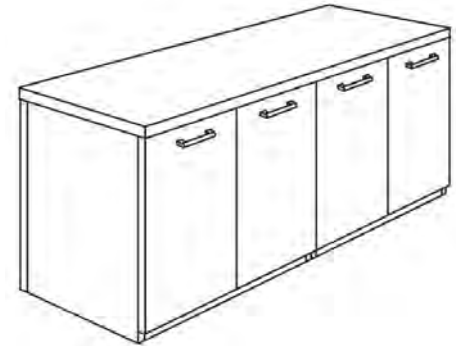

Finishes shown may not be representative of final color selections



Finishes shown may not be representative of final color selections



CONFERENCE

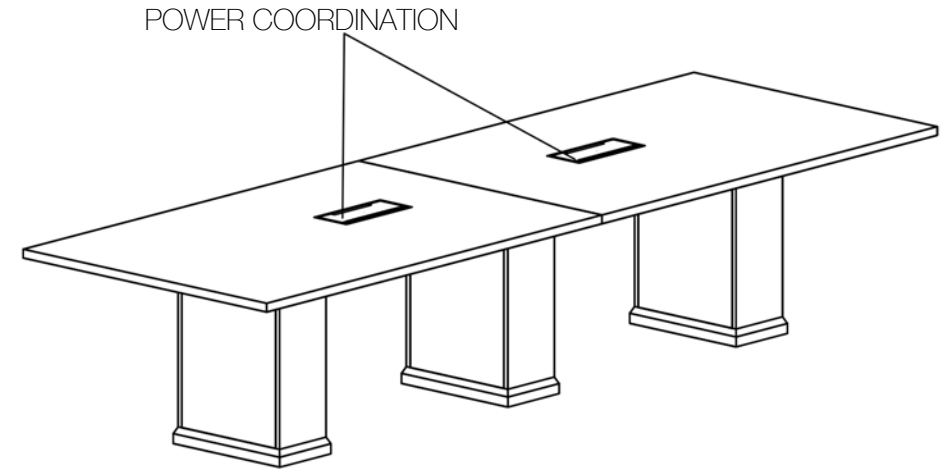

Finishes shown may not be representative of final color selections



Finishes shown may not be representative of final color selections



ADMINISTRATIVE

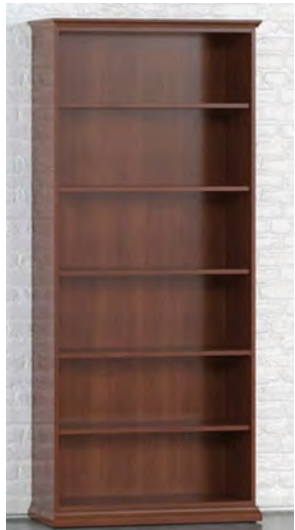

Finishes shown may not be representative of final color selections



Finishes shown may not be representative of final color selections



Finishes shown may not be representative of final color selections



ADMINISTRATIVE



Finishes shown may not be representative of final color selections



DEPARTMENTAL

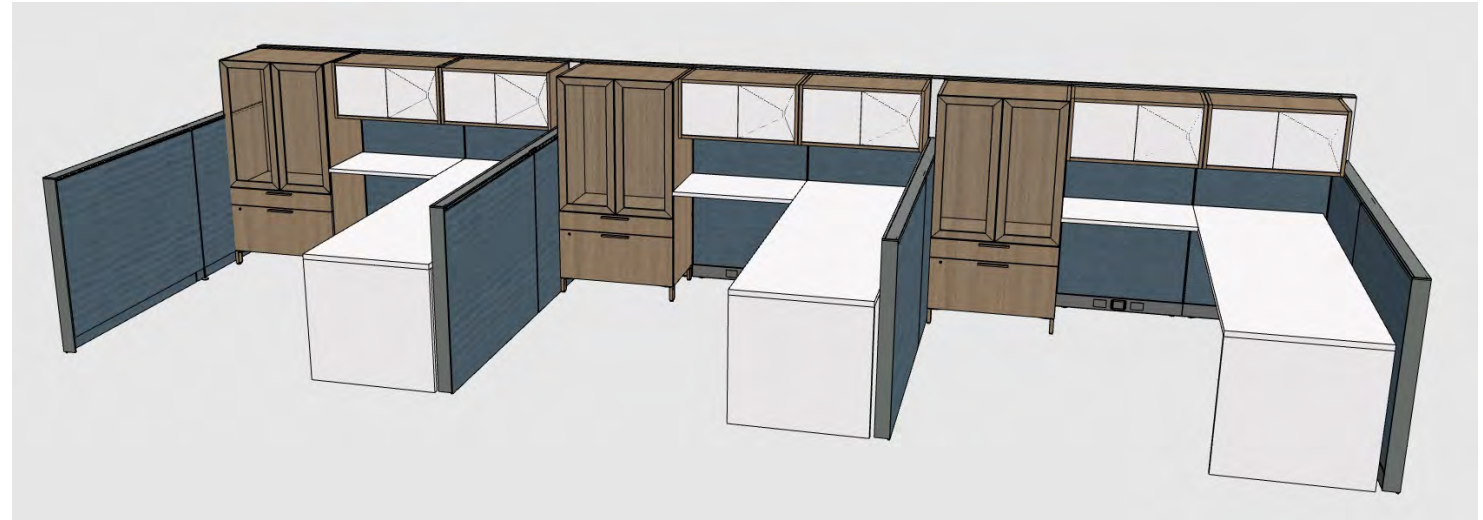
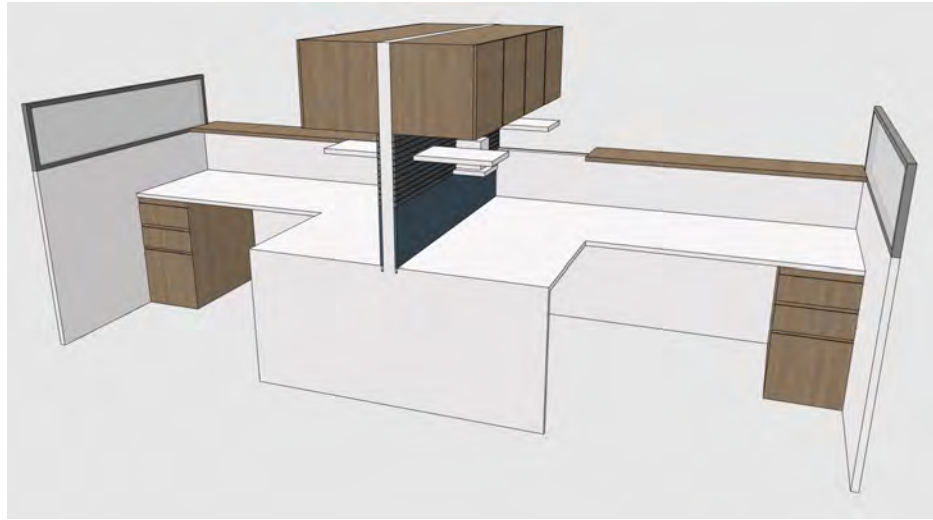

Finishes shown may not be representative of final color selections



COMMERCIAL GRADE MATERIALS

- **CLEANABLE & DURABLE**
- **MEETS & EXCEEDS SUGGESTED ABRASION TESTING**
 - **WYZENBEEK DOUBLE RUB TEST**
 - **COMMERICAL SUGGESTED RANGE: 30,000 – 100,000**
 - **PROPOSED PRODUCTS RANGE: 250,000 – 500,000**
- **MEETS COMMERCIAL GUIDELINES FOR FLAMMABILITY**





ERGONOMICS

- WEIGHT CAPACITIES
- ADJUSTABILITY

VARIETY

- ARM TYPES
- SEATING WIDTHS
- SIGHT LINES

WARRANTIES

- PRODUCT PROTECTION
 - REPAIR & REPLACEMENT
- CERTIFIED DEALERS
 - MAINTENANCE & REPAIR

TECHNICAL COORDINATION

- CONFERENCE TABLE POWER
- WORKSTATIONS



Advanced lumbar



High-performance casters



2-, 4-, 8-way arms



Ergo-curve seat



Intuitive mechanism



Modernized Y-support





SELECTION PROCESS

- **FURNITURE SELECTED BY REGISTERED INTERIOR DESIGNERS & ARCHITECTS**
- **NUMEROUS MEETINGS WITH COUNTY ELECTED OFFICIALS, DEPARTMENT LEADERSHIP & STAFF**
- **BALANCE OF SCOPE, BUDGET & ESSENTIAL FURNITURE NEEDS**
- **PURCHASING NEW FOR EFFICIENCY & CONSISTENCY**
- **COORDINATES WITH THE PURPOSE OF THE BUILDING**
- **APPROPRIATE SIZE, STYLE, & CONFIGURATION FOR THE NEW SPACE**





SPECIFICATION SHEETS

DETAILED DOCUMENTATION PROVIDED FOR COMPETITIVE BIDS

fitzpatrick

ARCHITECTS

DP01.3A

DESK - PRIVATE OFFICE

PROJECT: SMITH CO COURTHOUSE FURNITURE

ISSUE DATE: 4/23/26

PROJECT NUMBER: 23.001

REVISION DATE:

MANUFACTURER: JSI

COMPONENTS:

ITEM NAME: VISION MODULAR DESK

84" WALL MOUNT OVERHEAD CABINET WITH 4 DOORS

- LAMINATE DOORS

DIMENSIONS: 84"w x 102"d x 72"h

84" WALL MOUNT TACKBOARD FOR OVERHEAD CABINET

MODULAR BOX/BOX/FILE x 2

NOTES:

NO MODESTY PANEL

- LOCKS, BLACK ON PEDESTALS ONLY

BOOKCASE OVERHEAD

DRAWER PULL: DELVE, SOFT NICKEL FINISH

RECTANGULAR BASE

EASED EDGES
3 ARCTIC SILVER GROMMETS

1 MINI POWER TILT UP WITH WIRE TROUGH

MODULAR RECTANGULAR DESKTOP 30" x 84" & 30" x 54"

MODULAR PEDESTAL TOP 36" x 28"

COORDINATE FINAL POWER & GROMMET
LOCATIONS BEFORE FABRICATION

CONTACT INFO: Kelli Ratcliff, Ratcliff & Associates,
C:214.282.9355, kelli@ratcliffandassoc.com



PRODUCT IMAGE:

FINISHES:



HIGH PRESSURE LAMINATE (WOODGRAIN):
JSI PINNACLE WALNUT
CABINET BODY, DRAWERS

HIGH PRESSURE LAMINATE (SOLID):
JSI DESIGNER WHITE
WORKSURFACE TOP, OVERHEAD
CABINET DOORS

METAL:
JSI SOFT NICKEL

FABRIC:
MOMENTUM MARATHON C-ZERO
TINT

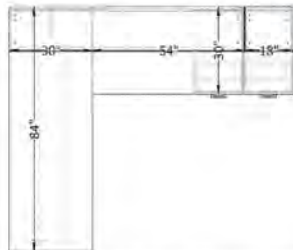

fitzpatrick

ARCHITECTS

TM01.2A

TABLE - MEETING

PROJECT: SMITH CO COURTHOUSE FURNITURE

ISSUE DATE: 4/23/26

PROJECT NUMBER: 23.001

REVISION DATE:

MANUFACTURER: JSI

COMPONENTS:

ITEM NAME: ANTHOLOGY RACETRACK

ARC BOAT TOP 144 X 48 WITH EASED EDGE

RACETRACK BASE KIT

WIRE MANAGEMENT VELCRO STRAPS

HDMI DATA PLATE, TYPE 1

DIMENSIONS: 144"w x 48"d x 29"h

NOTES:

POWERED - DOUBLE ELLORA: TWO SIDED, IN SURFACE
ALUMINUM FRAME WITH SOFT CLOSING LID AND CORD
ROUTING SLOT, EIGHT POWER UNITS, TWO USB A+C
PORTS, ONE HDMI PORT, CORDED (QTY 2 MIDDLE)

ALL LAMINATE TO BE HIGH PRESSURE LAMINATE

CONTACT INFO: Kelli Ratcliff, Ratcliff & Associates,
C:214.282.9355, kelli@ratcliffandassoc.com

PRODUCT IMAGE:

FINISHES:



HIGH PRESSURE LAMINATE (WOODGRAIN):
MANUFACTURER: JSI,
COLOR: PINNACLE WALNUT

METAL (IF APPLICABLE):
MANUFACTURER: JSI,
COLOR: SOFT NICKEL

POWER UNIT:
MANUFACTURER: JSI,
COLOR: SILVER

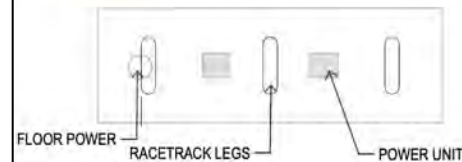



SPECIFICATION SHEETS

DETAILED DOCUMENTATION PROVIDED FOR COMPETITIVE BIDS

fitzpatrick ARCHITECTS

DW01

DESK - WORKSTATION

PROJECT: SMITH CO COURTHOUSE FURNITURE
PROJECT NUMBER: 23.001

ISSUE DATE: 2/12/26
REVISION DATE: 3/24/26

MANUFACTURER: HERMAN MILLER

ITEM NAME: CANVAS WALL

DIMENSIONS: 84"W X 60"D X 68"H
35"H PARTITION

NOTES:

- 2ND FLOOR COUNTY CLERK WORKSTATION W/ TRANSACTION COUNTER
- NEED WHIPS AT JUNCTION BOXES IN FLOOR. SEE PLAN FOR FLOOR POWER LOCATIONS
- COORDINATE WITH ARCHITECT FOR ANY REMAINING DESIGN DECISIONS
- ALL LAMINATE TO BE HIGH PRESSURE LAMINATE
- SEE FOLLOWING SHEETS FOR MORE INFORMATION

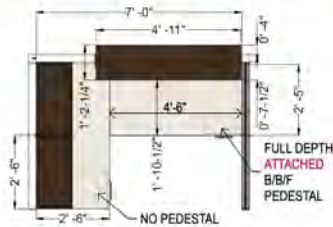

NOTE: THIS SHOWS A TYPICAL DESIGN, REFER TO PLANS FOR LAYOUT. FURNITURE VENDOR TO PROVIDE ALL NECESSARY COMPONENTS AND CONFIGURATIONS TO MEET DESIGN INTENT.

QTY: 23

PRODUCT IMAGE:

FINISHES:



NOTE: 3D VIEW SHOWN FOR CONCEPTUAL LAYOUT CONFIGURATION ONLY. FINISHES & DETAILS MAY NOT BE REPRESENTED ACCURATELY.

- HIGH PRESSURE LAMINATE (WOODGRAIN):**
HERMAN MILLER WALNUT ON ASH LBC
LOCATED: UPPER CABINETS, DRAWER PEDESTALS, TRANSACTION COUNTER
- HIGH PRESSURE LAMINATE (SOLID):**
HERMAN MILLER WHITE 91
LOCATED: WORKSTATION TOP AND END PANEL
- METAL:**
HERMAN MILLER WARM GRAY NEUTRAL WN
LOCATED: TRIM, RAILS, TOP CAP, BASE
- FABRIC:**
HERMAN MILLER WHISPER BLUEBERRY 1W15
LOCATED: WALLS / TILES

CONFIRM HANDLE STYLE BEFORE FINALIZING DESIGN

fitzpatrick ARCHITECTS

DW01

DESK - DETAILS

PROJECT: SMITH CO COURTHOUSE FURNITURE
PROJECT NUMBER: 23.001

ISSUE DATE: 2/12/26
REVISION DATE: 3/24/26

MANUFACTURER: HERMAN MILLER

ITEM NAME: CANVAS WALL

DIMENSIONS: 84"W X 60"D X 68"H
35"H PARTITION

NOTES:

- TRANSACTION COUNTER NO MORE THAN 4" OVERHANG INTO WALKWAY
- LOCKABLE UPPER CABINETS AND PEDESTAL DRAWERS (SILVER 613 LOCKS)
- ATTACHED FULL DEPTH BOX/BOX/FILE PEDESTAL WITH FRONTS TO FLOOR
- ALL TILES TO BE WHISPER BLUEBERRY TACKABLE FABRIC WITH WARM GREY NEUTRAL BEAD FINISH
- ALL LAMINATE TO BE HIGH PRESSURE LAMINATE, INCLUDING WORK SURFACE, SUPPORT PANELS, CABINETS AND PEDESTALS
- INCLUDE ONE HANGING PENCIL CLIP, ONE DIAGONAL TRAY AND TWO PAPER TRAYS ON RAIL
- 15"H FRAME TOP SCREEN, OPAL ETCHED GLASS - 1/4" THICK
- NEED WHIPS AT JUNCTION BOXES IN FLOOR. SEE PLAN FOR FLOOR POWER LOCATIONS
- COORDINATE POWER BETWEEN STATIONS
- PROVIDE NECESSARY POWER TO PANELS
- PROVIDE 2 LOGIC MINI GROMMET MOUNT POWER OUTLET AND USB OUTLET ABOVE COUNTER
- PROVIDE HINGED CABLE MANAGEMENT TROUGHS WITH POWER PLUG STRIP
- STANDARD SILVER 613 BAR DRAWER PULLS
- 3 STANDARD WHITE 91 GROMMETS (1 CORNER, 2 MIDDLE OF EACH WORK SURFACE)
- COORDINATE WITH ARCHITECT FOR ANY REMAINING DESIGN DECISIONS

fitzpatrick ARCHITECTS

DW01

ACCESSORIES

PROJECT: SMITH CO COURTHOUSE FURNITURE
PROJECT NUMBER: 23.001

ISSUE DATE: 2/12/26
REVISION DATE: 3/24/26

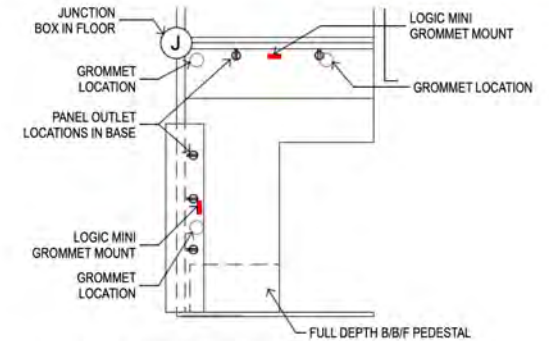

NOTE: THIS SHOWS A TYPICAL DESIGN. LOCATIONS SHOWN ARE APPROXIMATE. VENDOR TO COORDINATE FINAL LOCATIONS BEFORE ORDERING.

ACCESSORIES

LOGIC MINI (QTY 2)



DIAGONAL TRAY (QTY 1)



PENCIL HOLDER (QTY 1)



PAPER TRAY (QTY 2)





FURNITURE PACKAGES

- **PROJECT SCOPE DIVIDED INTO 10 PACKAGES**
- **GREATER OPPORTUNITY FOR COMPETITIVE BIDDING BY CERTIFIED DEALERS**

AWARDING CONTRACTS

- **ADDITIONAL TARIFFS & PRICE INCREASES COMING IN JUNE**
- **BEGIN ORDERING PROCESS TO ACCOMMODATE LEAD TIMES**
- **FORECASTED AT \$3.8M IN 2023**
- **RESERVED IN SOFT COST \$3.75M**
- **COMPETITIVE BIDDING AT \$3.5M**
- **RESERVING ± \$200,000 CONTINGENCY FOR END OF PROJECT NEEDS**

- **PACKAGE 1 – DESKING**
- **PACKAGE 2 – DESKING & SEATING**
- **PACKAGE 3 – SEATING**
- **PACKAGE 4 – LOUNGE**
- **PACKAGE 5 – WORKSTATIONS (CUBICLES)**
- **PACKAGE 6 – BENCHING (COMPUTER TABLES)**
- **PACKAGE 7 – LIBRARY SHELVING**
- **PACKAGE 8 – STORAGE**
- **PACKAGE 9 – PLANTER (MAIN LOBBY)**
- **PACKAGE 10 – UTILITY**



fitzpatrick
ARCHITECTS

